

# APPLICATION/PERMIT TO CONSTRUCT AND OPERATE UTILITY FACILITIES ON HIGHWAY RIGHT-OF-WAY

s.66.047,84.08, 85.15, 86.07(2), 86.16, 182.017 and such other applicable Wis. Stats.

|  |  |
|--|--|
| Location Description - Quarter section, section, township, range, etc.<br>To each copy of the application attach one copy of the sketch showing location.<br><br>See page 2  | Proposed Work Location<br><input type="checkbox"/> Town <input type="checkbox"/> Village <input checked="" type="checkbox"/> City<br>of: <b>Madison</b><br>County<br><b>Dane</b> |
| Applicant Name and Address<br><b>Wisconsin Department of Administration<br/>                 Division of Enterprise Technology<br/>                 101 East Wilson Street<br/>                 Madison, WI 53707-7896<br/>                 c/o: Mr. Matt Miszewski      Phone: 608-264-9502</b> | Construction Starting Date<br><b>On Approval</b><br>Construction Completion Date *See Note Below<br><b>December 31, 2005</b><br>Applicant Work Order - if any<br><b>N/A</b>      |

|  |   |  |  |
|--|---|--|--|
| Highway  | Utility Facility/Work Type  | Line Orientation                                       | Trans. 401 Project Designation<br><small>(See policy 96.55)</small>  |
| <input checked="" type="checkbox"/> <b>STH 30</b>        | <input type="checkbox"/> Electric <input type="checkbox"/> CATV   | <input type="checkbox"/> Overhead                      | <input checked="" type="checkbox"/> <b>Minor</b>   |
| <input checked="" type="checkbox"/> <b>USH 12/18, 51</b> | <input checked="" type="checkbox"/> Telephone/<br>Communications <input type="checkbox"/> Gas/Petroleum | <input checked="" type="checkbox"/> <b>Underground</b> | <input type="checkbox"/> Major   |
| <input checked="" type="checkbox"/> <b>Interstate 90</b> | <input type="checkbox"/> Water <input type="checkbox"/> Chemical Treatment                              | <input type="checkbox"/> Bridge Attachment             | For Major projects only,<br>the utility shall notify the<br>department at least 24<br>hours prior to the<br>installation of erosion<br>control and storm water<br>management measures<br>Trans. 401.09(1). |
|  | <input type="checkbox"/> Sanitary Sewer <input type="checkbox"/> Tree Cutting/Removal                   |  |  |

\* NOTE: If the work described is not completed by the "Completion Date" specified, this permit is null and void, and the work shall not be completed unless authorized through a subsequent permit or an approved time extension.

|   |   |   |   |
|---|---|---|---|
| Utility Person Responsible for Construction<br><b>Keith White, Henshue Construction</b> | Area Code - Telephone Number<br><b>608-271-6719</b> | Utility or Project Emergency Contact<br><b>Matt Miszewski</b> | Area Code - Telephone Number<br><b>608-264-9502</b> |
|---|---|---|---|

It is understood and agreed that approval is subject to the applicant's full compliance with the pertinent Statutes, as well as any rules and regulations of other jurisdictional agencies, which may be more restrictive, and with the Wisconsin Department of Transportation's Utility Accommodation Policy, current edition.

Are You a member of Diggers Hotline?

Yes

No, provide line-locate number

|  |                          |
|--|--------------------------|
| (Signature of Authorized Representative - If filled via computer, Brush Script font)                 | <b>10/8/05</b><br>(Date) |
| <b>Keith White    keithw@henshue.com</b><br>Project Manager<br>Henshue Construction, Inc.<br>(Title) |                          |
| <b>608-219-1621</b><br>(Authorized Representative Telephone Number)                                  |                          |

|   |   |
|---|---|
| WisDOT Contact, Office Address and Telephone Number<br><b>Bob Fasick<br/>                 Wisconsin Department of Transportation<br/>                 Bureau of Highway Operations<br/>                 PO Box 7986 - Room 501<br/>                 Madison, WI 53707-7986<br/>                 608-266-3438    robert.fasick@dot.state.wi.us</b> | Date Application Received by WisDOT<br><b>SW Region Office - 9/29/05<br/>                 BHO Office - 10/11/05</b> |
|---|---|

SEE SUPPLEMENTAL PERMIT PROVISIONS

|   |                          |
|---|--------------------------|
| <input type="checkbox"/> The applicant shall contact the Transportation Regional Office at the Telephone Number given at right NOT LESS THAN 3 WORKING DAYS prior to the start of the permitted work to arrange for a Regional Representative to locate and mark the existing traffic signal and/or highway lighting lines. No work under this permit shall be accomplished prior to the Regional Representative's arrival. | Special Telephone Number |
|---|--------------------------|

### Wisconsin Department of Transportation Permit Approval

|                                |                                  |
|--------------------------------|----------------------------------|
| Permit Number<br><b>000837</b> | Issuance Date<br><b>11/17/05</b> |
|--------------------------------|----------------------------------|

(WisDOT Authorized Representative Signature - If filled via computer, Brush Script font)

## Indemnification

To the extent provided by law, the State will pay for the costs and damages caused by the negligent acts of any officer, employee or agent acting within the scope of his or her State of Wisconsin authority. The State of Wisconsin is self-funded for liability purposes. All claims must be filed pursuant to applicable Wisconsin Statutes.

## Location Description by Project Sections

### North Route

- Eastbound STH 30 from the Wisconsin & Southern RR to eastbound I-90 (includes crossing USH 51)
- NE  $\frac{1}{4}$ .NE  $\frac{1}{4}$  and SE  $\frac{1}{4}$ .SE  $\frac{1}{4}$  of Sec. 3 and W  $\frac{1}{2}$  of Sec. 11, 14, and 23 of T.7N-R.10E
  
- Eastbound I-90 from STH 30 to Femrite Drive
- NW  $\frac{1}{4}$  and NE  $\frac{1}{4}$  of Sec. 4 (South of S.T.H. 30) and NW  $\frac{1}{4}$  of Sec. 27 and NE  $\frac{1}{4}$  of Sec. 28 (North of U.S.H. 12/18) T.7N.-R. 10E
- NE  $\frac{1}{4}$  .NE  $\frac{1}{4}$  of Sec 5 and N  $\frac{1}{2}$  of Sec.4 and 3 of T.7N.-R. 10E

### South Route:

- Westbound USH 12/18 from the Wisconsin & Southern RR to eastbound I-90 (includes crossing USH 51)
- NE  $\frac{1}{4}$ .NE  $\frac{1}{4}$  Sec. 36 T.7N. -R.9E. N  $\frac{1}{2}$  Sec. 30, 29, 28, 27, 26 and SE  $\frac{1}{4}$ .SW  $\frac{1}{4}$  of Sec. 23 T.7N. -R. 10E
  
- Eastbound I-90 from USH 12/18 to Femrite Drive
- NW  $\frac{1}{4}$  .NE  $\frac{1}{4}$  of Sec 26



# BLOOMING GROVE

# T.7N.-R.10E.

SEE PAGE 37

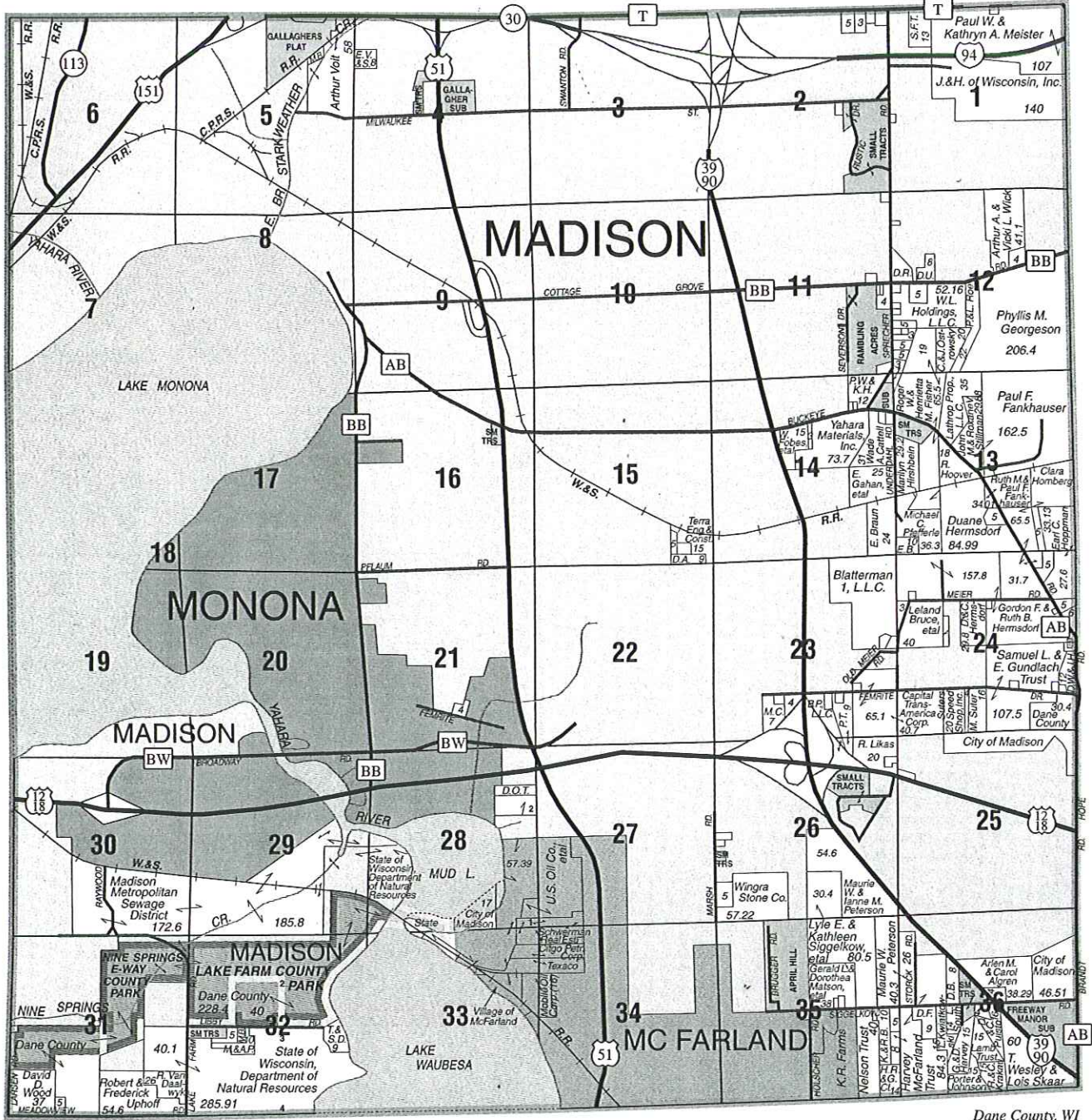

Dane County, WI

© 2002 Rockford Map Publs., Inc.

SEE PAGE 22

SEE PAGE 29

4752  
4488  
4224  
3960  
3696  
3432  
3168

SEE PAGE 27

SEE PAGE 21

4752      4488      4224      3960      3696      3432      3168

# DOA Fiber Optic Project

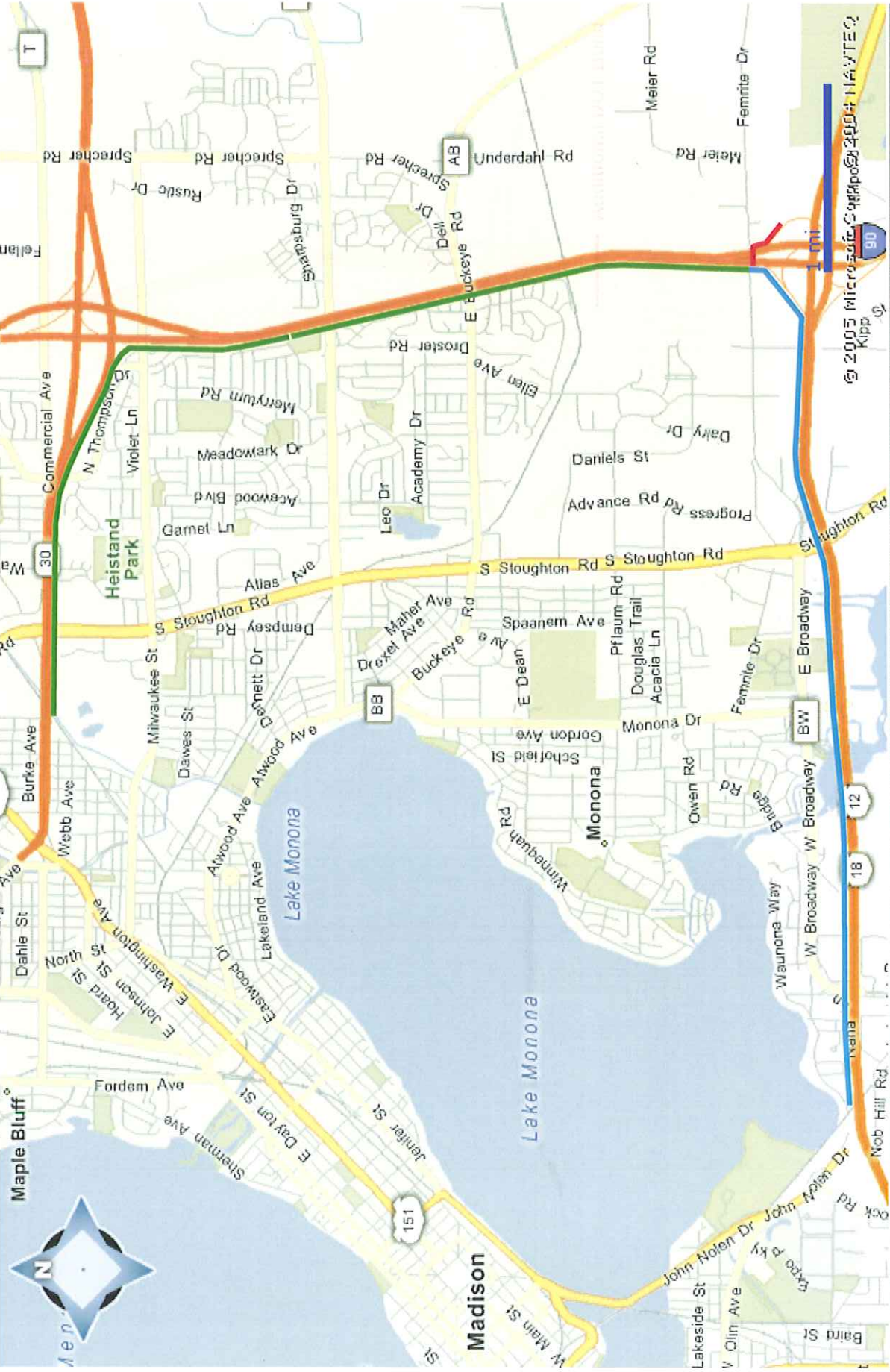

North Route

South Route

Additional DOT Build



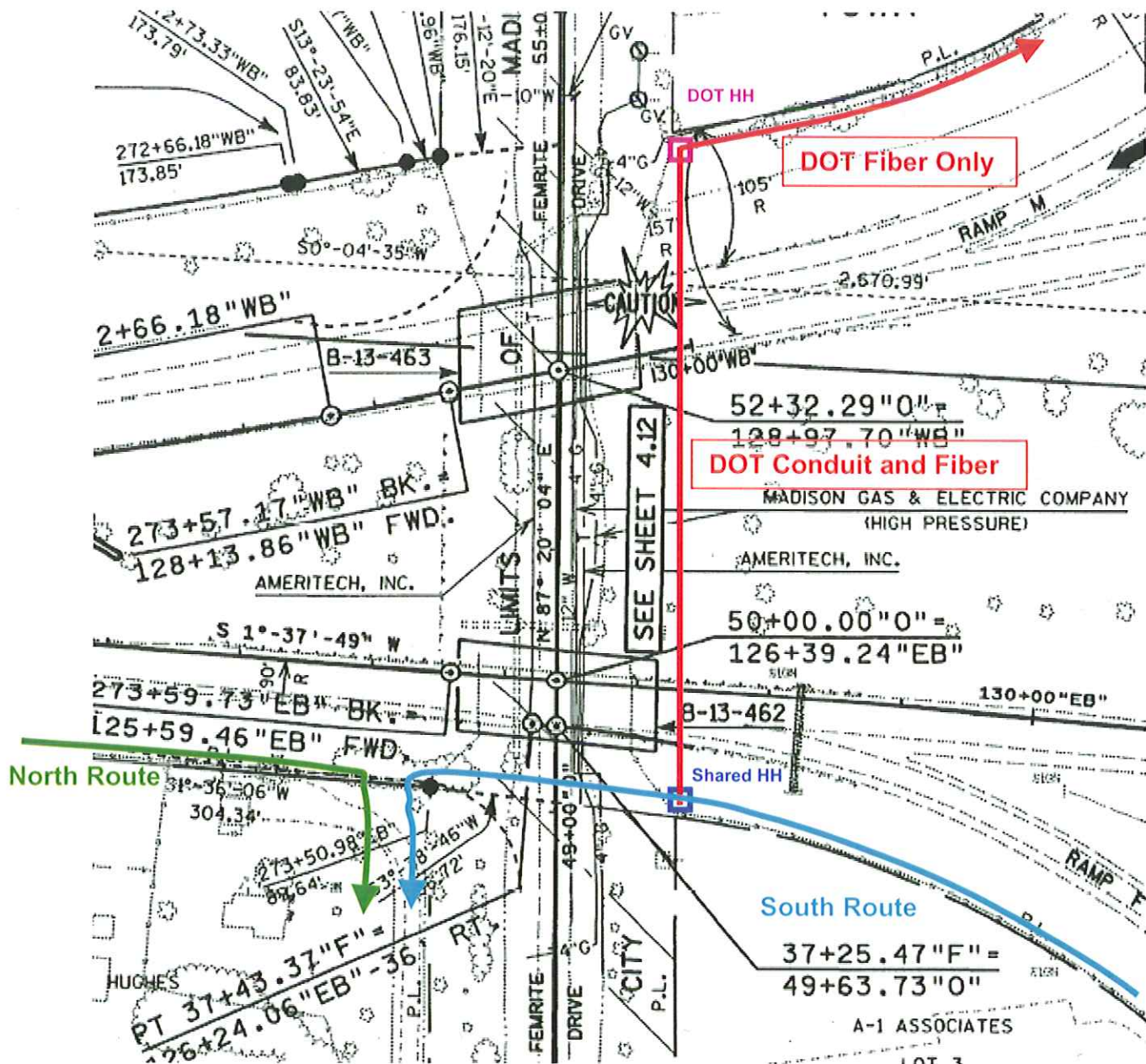

**Additional DOT conduit and fiber layout**



**SUPPLEMENTAL PERMIT PROVISIONS**  
State of Wisconsin, Department of Administration  
Permit #000837 – Issued 11/17/05  
STH 30, USH 12/18 (West Beltline Hwy), USH 51, I-90  
City of Madison, Dane County

**Project description:** The Department of Administration (DOA) is building a communications facility to connect to its new data center on Femrite Drive just west of I-90. The project is divided into two routes – north and south – and uses Wisconsin Department of Transportation (DOT) right-of-way along the highways noted above. The north route starts at the Wisconsin and Southern Railroad tracks just west of USH 51 (Stoughton Road), and then runs eastbound along STH 30 and I-90 to Femrite Drive. The south route starts at the Wisconsin and Southern Railroad tracks east of John Nolen Drive, and runs along westbound USH 12/18 to I-90 and then Femrite Drive.

The north route facility consists of two, 1½" outside diameter HDPE conduits. Inside one of those conduits, a 360-fiber cable approximately one inch in diameter will be installed. The south route consists of two, 1½" outside diameter HDPE and one, 1¼" outside diameter HDPE conduits. Inside one of the 1½" conduits, a 360-fiber cable approximately one inch in diameter will be installed for DOA. Inside the 1¼" conduit, a 12-fiber cable will be installed for DOT, which shall be entirely dark fiber. In addition to the conduits, there will be a number of handholes placed at road and railroad crossings along the entire project route to accommodate future facility moves due to highway and/or bridge improvement projects.

- 1) **DOA PERMIT RIGHTS.** This permit grants DOA the right to construct, operate and maintain underground longitudinal communication facilities on DOT right-of-way. The construction only covers the initial installation of DOA's facilities. If DOA needs to reconstruct, replace, or repair its facilities beyond the items listed in maintenance sections 96.61/.62 of DOT's *Utility Accommodation Policy (UAP)*, it shall first obtain prior approval in the form of a permit from DOT. DOA may respond to any facility related emergency without first obtaining a permit from DOT so long as it follows *UAP* guidelines while handling the emergency. If necessary, DOA shall submit a permit application after the emergency to document any changes to its facility.

This permit is subject to the attached drawings and specifications, these supplemental provisions, and the *UAP*. All costs associated with this permit shall be DOA's responsibility unless otherwise indicated. This permit does not grant DOA any property right or interest in DOT right-of-way.

- 2) **DOA AGENTS.** With regards to this permit, DOA has authorized Finley Engineering (Eau Claire) and Henshue Construction (Madison) to be its agents and act on behalf of DOA. This includes development of the permit plans, signing the permit application, and construction of the facility.
- 3) **PERMIT TERM LENGTH.** The permit term shall be **30** years from the date of signing by DOT. DOA shall have the option to renew for one, successive **30**-year term. If DOA exercises its option to renew, then DOA and DOT agree to begin negotiations regarding any alterations that may be necessary to the original permit at least one year prior to its expiration date. If the original permit expires before it can be renewed, DOA shall be allowed to continue to occupy the right-of-way, however, such occupancy shall be on a month-to-month basis under the same terms and conditions as this permit except an annual fee will also be charged (converted to monthly payments) using the guidelines as listed in the *UAP* at that time.
- 4) **NOTICE OF TERMINATION.** This permit may be terminated at any time upon mutual consent of DOA and DOT. If only one party requests termination of the permit or specific locations within the permitted route, both parties shall meet to discuss the situation and come to a consensus on terms before termination can occur.
- 5) **LONGITUDINAL OCCUPANCY FEE / BARTER ARRANGEMENT.** Because the installation of DOA's facilities are on DOT controlled-access highway right-of-way, a longitudinal occupancy fee shall be charged to DOA for the use of the right-of-way as a condition of its permit. In lieu of that fee being paid to DOT, DOA agrees to install a separate 1¼" HDPE conduit containing a 12-fiber cable along the south route, which shall be located next to DOA's facility. In addition, DOA agrees to install a 1¼" conduit by boring under I-90 parallel to Femrite Drive for approximately 500'. A handhole will be installed on westbound I-90 that ties in with existing DOT conduit. From the eastbound I-90 handhole at Femrite Drive, DOA will install approximately 2,300' of 12-fiber in the DOT conduit to an existing DOT handhole approximately 1,700 feet south of Femrite Drive. DOA will also install four handholes solely for DOT use at locations determined by DOT in addition to those required for road and railroad crossings. **All items provided by DOA will be at DOA's cost, but will become DOT's property upon installation.** See plan drawings for location details.

- 6) **FIBER & HANDHOLES.** DOA shall own, maintain, move, and locate its 1½" conduits and contents at DOA expense. DOT shall own, maintain, move, and locate its 1¼" conduit and contents at DOT expense. Handholes used only by one agency shall be maintained by that agency. DOA shall manage shared handholes (south route only), however, any costs to move or maintain them, etc., will be paid for at the following rate: DOA – 67%, DOT – 33%. DOT shall notify DOA when DOT needs to access a shared handhole.
- 7) **COORDINATION WITH DOT LANDSCAPING PROJECT 1002-02-73.** An existing DOT improvement project will plant trees and vegetation in front of the sound barrier on I-90 from Milwaukee Street to the railroad tracks just south of Buckeye Road (CTH AB). DOA shall coordinate with the project manager, Joe Jirsa, 608/628-2785, or Bruce Woods, 608/251-3600, both of Foth & Van Dyke to ensure that interference with DOT's project is kept to a minimum. DOA shall be responsible for any additional costs incurred by DOT's landscape contractor that can be documented as a result of DOA's facility installation.
- 8) **WORK-TIME RESTRICTIONS DURING CONSTRUCTION.** When all work is **entirely** outside the clear zone (30 feet from edge of pavement), there are no work-time restrictions. For any work that occurs inside the clear zone, including the closure of a shoulder, such work shall not occur between the hours of 6-9 AM and 3-6 PM on weekdays on both westbound USH 12/18 and eastbound I-90.
- DOA may work on Saturdays, Sundays, and at night. Work under this permit shall not be accomplished on any legal holiday. Work shall also comply with all City of Madison noise ordinances. Motorized construction equipment shall not be operated from 9 PM – 6 AM unless prior written approval is obtained from DOT.
- 9) **TRAFFIC CONTROL.** All work zone traffic control shall be in accordance with the Wisconsin Manual on Uniform Traffic Control Devices. Additional guidance is available from DOT through a booklet entitled, *Work Zone Safety, Guidelines for Construction, Maintenance, and Utility Operations* or from *UAP 96.51*. For operations in which the **entire** work zone **continuously** remains more than 30 feet from the edge of the closest traffic lane, work zone signing is not required. Any DOA work zone signing shall not conflict with the work zone signing with DOT's landscaping project (provision 7).
- 10) **ACCESS.** Access to the work site shall be from adjacent lands whenever practicable. When it is not practicable, equipment may be loaded and unloaded from the shoulder subject to proper work zone traffic control and work-time restrictions (provision 8). No lane shall be closed for any reason unless prior approval has been obtained from DOT.
- 11) **WORK SITE STORAGE.** DOA shall store project vehicles, equipment, and materials off of the right-of-way during non-work times if possible. If necessary, DOA may store project vehicles, equipment, and materials on the right-of-way provided they are placed as close to the right-of-way line as possible, but no less than 30 feet from the edge of the nearest travel lane. DOA shall ensure that any excavation left open during non-work times is well marked and secured from public intrusion.
- 12) **TREES/VEGETATION.** Certain trees and other vegetation may be removed to accommodate construction along each route. See appendix A for details. All items scheduled for removal shall be clearly marked in the field and approved by DOT **prior to any removal**. No items shall be removed in the I-90 corridor along the sound barrier without the prior consent of DOT's landscaping project manager (provision 6). Newly planted trees and other vegetation from this project that need to be replaced shall be at DOA's cost. In addition, DOA shall pay all costs associated with potholing (vacuum excavating) its finished facility, if needed, to give DOT's landscape contractor an accurate location of the facility in order to facilitate tree planting and prevent facility damage.

DOT shall not require DOA to replace trees and vegetation removed along USH 12/18 unless there is a significant public outcry over the removal of a tree or a group of trees. Replacement trees shall be at DOA's cost and provided at a ratio of two items planted for every one removed. All trees shall be a minimum of 2-inch± caliper. If required, a landscape plan shall be submitted to and approved by DOT prior to the planting of any new vegetation. DOA shall maintain all newly planted trees and vegetation for a 2-year period. If any trees or vegetation die within that period, DOA shall replace and maintain them for another 2-year period.



**13) EROSION CONTROL.** DOA's project is categorized as "minor" under UAP 96.55. A formal erosion control plan is not required, but DOA shall perform best management erosion control practices throughout all project phases to ensure that there are no adverse erosion effects. DNR permit review has been completed and sensitive wetland areas have been identified. Those areas shall be avoided by boring underneath them, except for one area as designated on south route sheet 10 in which DOA will be allowed minor hand digging to connect two bore endpoints. Temporary seeding shall be used after rough grading and before completion of the project. DOA shall ensure that erosion control measures used to protect restored areas remain in place until replacement vegetation achieves sustained growth.

**14) RESTORATION.** DOA shall restore any DOT right-of-way disturbed as a result of this project to its original (as best as practical) condition within **two weeks** after installing its facilities. Upon notification from DOT, DOA shall temporarily restore rutted right-of-way up to 15 feet from the edge of shoulder **one week** prior to the scheduled date of mowing operations in the area. DOT may allow time extensions for restoration in the case of inclement weather or if DOA's operations would track over the same disturbed areas – provided that proper erosion control devices are in place to protect the disturbed areas.

If DOA fails to do restoration within the required time period, DOT shall have the right-of-way restored and bill DOA for the work. Special seed mixes may be required by DOT for surface restoration to prevent the establishment of non-native forbs and grasses in the area. DOA's contractors shall thoroughly wash all equipment before bringing it to the job site if it was used in other states prior to being in Wisconsin.

Should future maintenance work on DOA's facilities result in the disturbance of the existing right of way, DOA shall restore the right of way to its original condition as soon as possible. The basic drainage pattern of the highway shall remain undisturbed by the permitted work. Upon project completion, all spoils, debris, refuse, and waste resulting from the permitted work shall be removed from the work site.

**15) FENCING.** DOA may remove any portion of DOT's existing security fence during construction, and shall be responsible for effectively restricting access by others during the period when the fence is open. Overnight, the security fence shall be restored, a temporary fence installed, a locked gate installed, or some other way of securing the fence used to deter access by people and animals.

**16) HIGHWAY SIGNS.** No green guide or blue specific information signs shall be moved during the project.

**17) FUTURE HIGHWAY CONSTRUCTION.** The design and construction of DOA's facilities takes into consideration as much as is currently known about future DOT construction of the:

- > Westbound USH12/18 entrance ramps (for metering) between Stoughton Road and John Nolen Drive
- > Additional lanes in each direction on USH 12/18 and I-90
- > Milwaukee Street, Buckeye Road (CTH AB), and Cottage Grove Road (CTH BB) bridges over I-90.

As of the approved date of this permit, there are no design plans that would require relocation of DOA's proposed facilities, but DOA understands that it could occur due to any of the projects noted above.

**18) FACILITY RELOCATION.** DOA shall be given an opportunity to relocate its facility within DOT right-of-way if a highway project or other DOT-approved use conflicts with its location. In keeping with DOT's policy on compensable and non-compensable utility facility moves, DOT shall not compensate DOA to move its facility located within the right-of-way as part of a highway project. If it is necessary to maintain uninterrupted service, DOA shall be allowed to temporarily locate to another area of DOT right-of-way at a mutually acceptable location for up to 180 days during the relocation of its facilities to another permanent site. DOT agrees to make every reasonable effort to avoid relocation of DOA facilities in the future.

**19) ADJACENT FACILITIES.** DOT may approve the longitudinal location of a new utility facility or other improvement adjacent to DOA's facility within five feet of the facility or within limits specified by Department of Commerce standards for utility facility separation, whichever is greater. DOT shall require the new utility facility owner to notify DOA prior to construction of its facility, and to coordinate with DOA whenever there is a potential conflict between the two facilities.

**20) NOTIFICATIONS.** DOA shall notify Warren LaDuke, Transportation District 1 Utility Permit Coordinator for Dane County, at 608/246-3852, three working days prior to the start of construction. DOA shall call Diggers' Hotline 800/242-8511 at least three working days prior to the start of any excavation.

When a future DOT improvement project may affect DOA's permitted facilities, DOT shall use the Trans 220 process to notify DOA of the project. Currently, DOA's representative for receiving notification is Jim Schmolesky, Wisconsin DOA, Division of Enterprise Technology, 101 East Wilson Street, PO Box 7844, Madison, WI 53707-7844. Telephone: 608/266-1952 Fax: 608/267-0626

**21) VERTICAL LOCATION WITHIN CORRIDOR.** The facility shall be placed at a minimum depth of 36".

**22) HORIZONTAL LOCATION WITHIN CORRIDOR.** DOA shall place its facility as shown on the approved permit drawings and specifications. Any deviations to those locations shall be prior approved by DOT.

**23) ABOVEGROUND FACILITY MARKING.** Carrier may mark its facility with aboveground markers spaced at a maximum of 1,000 feet and at critical locations at road, railroad, and culvert crossings. It is suggested that markers be placed on each side of a road crossing when successive markers cannot be seen to better outline the approximate alignment. The markers should be designed to notify anyone near the facility as to its approximate location, but be small enough that they are not readable from the highway.

**24) PERMIT DRAWINGS AND SPECIFICATIONS.** Stationing herein provided is DOA project stationing, and the drawings are not to scale. **Note: Please carefully review the drawings to see where WisDOT has made additions or corrections.**

Date of provisions: 11/17/05

---

New supplemental permit provisions may be added or the existing ones deleted or amended in the future as different issues arise during the installation and maintenance of DOA's facilities.

## Appendix A: Working Around Trees & Tree/Vegetation Removal

The following guidelines have been developed when working around trees and other types vegetation (see next page for graphic representation). DOA:

- 1) Shall bore underneath trees **planted** by DOT for aesthetics, living snow fence, or screening, along with those **volunteer** trees greater than 8-10" DBH (diameter measured at breast height). DOT shall identify planted and volunteer trees in all locations prior to any construction.
- 2) May remove **isolated, volunteer or scrub** trees that are less than 8" DBH unless it is a visual landmark or adjacent to a property owner's home.
- 3) May locate its facility inside (towards the highway) any **isolated** trees, a **stand** of trees, or **planted** snow-fence provided there will be 50 feet or more from the edge of pavement (painted stripe) to the proposed facility location, and at least 8 more feet from that location to the nearest tree trunk greater than 8-10" DBH, or at least 4 more feet to the nearest edge of living snow-fence. A few (less than 5) trees greater than 8-10" DBH may be removed on the edge of a stand to improve the running line if needed.
- 4) May locate on the backside of the security fence within the 3-foot typical area between the fence and the right-of-way line to avoid a **stand** of trees. Carrier shall first verify with DOT before installation that the 3-foot area exists.
- 5) May clear up to a 13-foot swath of **volunteer or scrub** trees or brush from the fence line. *Brush is defined as trees or vegetation up to 1½" in diameter*
- 6) Shall not clear **any** trees or vegetation that serve as a visual barrier between an adjacent property owner and a sound barrier or the highway.
- 7) Shall not break off any lower branches to accommodate equipment passing nearby. Instead, these branches shall be properly pruned.

DOA shall arrange for the removal of all stumps, branches, logs, and other debris resulting from its cutting and trimming operations and for the disposal of such materials off of the right-of-way. Trees may be chipped and mulched on the right-of-way. DOA shall comply with applicable laws that regulate the pruning/cutting of trees.

To prevent Oak Wilt Disease from spreading, oak trees shall not be cut or pruned between April 15 and October 15 unless a thick coat of asphalt base tree paint is applied immediately after **any** cut, pruning wound, or abrasion made between those dates. DOA shall adhere to any applicable City of Madison ordinance if it is stricter than DOT specifications. Any roots encountered, either during grading or trenching, shall have the exposed ends cut cleanly with suitable pruning tools immediately after they have been exposed.



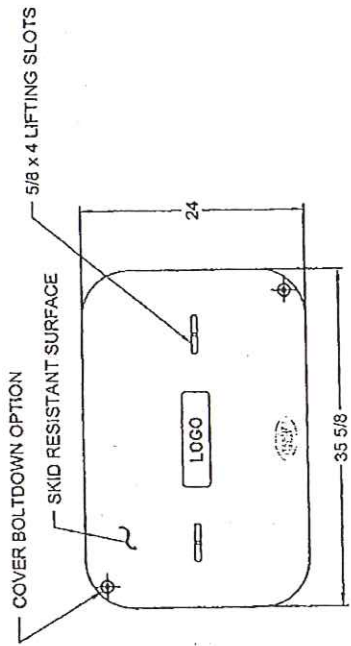

**COVER BOLTDOWN OPTION**

- MATERIAL: FIBERGLASS REINFORCED POLYMER CONCRETE & FIBERGLASS REINFORCED POLYMER
- STANDARD COLOR: CONCRETE GRAY
- (OPTIONAL COLORS AVAILABLE FOR COVER AND COLLAR)
- \*FLARED WALL BOXES ARE NESTABLE

|  |                        |
|--|------------------------|
| <b>cdr SYSTEMS CORP</b><br>146 SOUTH ATLANTIC AVE., ORMOND BEACH, FL 32176 |                        |
| TITLE: <b>24 x 36 SERIES</b><br>BOX, COVER & EXTENSION                     |                        |
| DRAWN: <b>MMK</b>  | DATE: <b>1/25/05</b>   |
| CHECKED: <b>A</b>  | ISSUE: <b>031-0002</b> |
| APPROVED: <b>ACK</b>   |                        |

**COVER**

OPTIONAL CAST IRON READER LIDS AVAILABLE

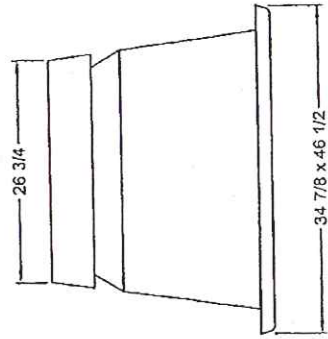

END

OPTIONAL KNOCKOUTS OR TERMINATORS

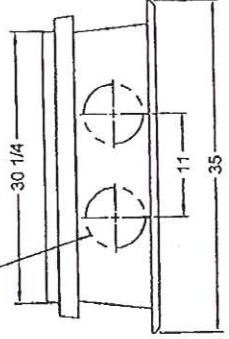

END

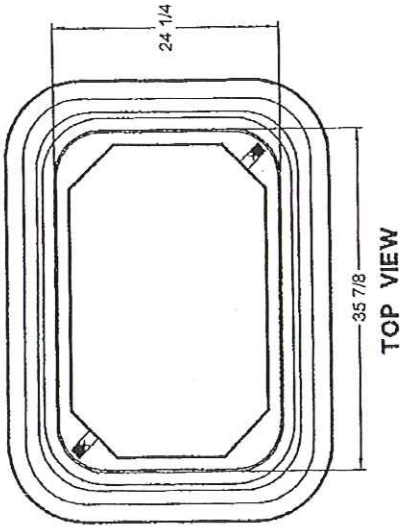

**TOP VIEW**

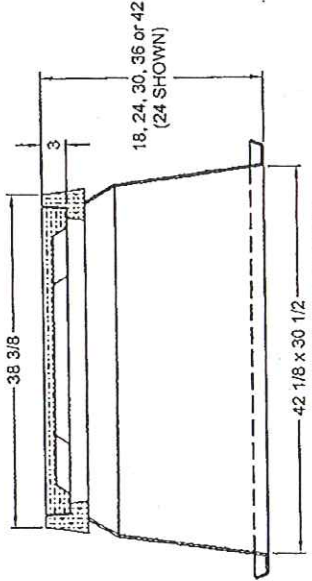

**BOX & COVER SECTION**

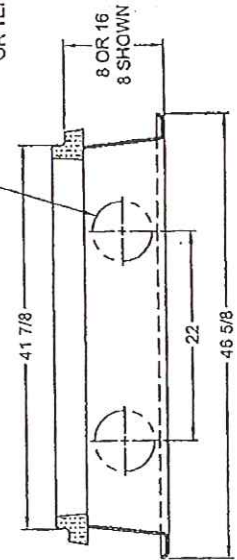

**EXTENSION SECTION**



**SYSTEMS CORPORATION**

146 SOUTH ATLANTIC AVENUE • ORMOND BEACH, FL 32176 • TEL: 386-615-9510 • FAX: 386-615-9606 • E-MAIL: sales@cdrsystems.com

# 24 X 36 BOXES

## FLARED WALL BOXES

FOR SPLICE BOXES – HANDHOLES – METER BOXES  
FIBER OPTICS

- **STRONG** - 4 to 5 times the strength of concrete
- **LIGHTWEIGHT** - Quick easy installation for **LOWEST INSTALLED COST**
- **AVAILABLE** - Light traffic or Heavy duty design
- **NESTABLE** - for easy storage, transportation and freight savings (for flared wall boxes only)
- **NON-CONDUCTIVE** - And unaffected by UV light, moisture, freezing and sub soil chemicals
- **STAINLESS STEEL HARDWARE** - non-corrosive
- **NO EXTRA CHARGE** - for standard cover logos

### Assemblies

| Box and Cover | COVER      |        | LIGHT TRAFFIC |     | HEAVY DUTY   |     |
|---------------|------------|--------|---------------|-----|--------------|-----|
|               | NOT BOLTED | BOLTED | Part No.      | WT. | Part No.     | WT. |
| 18" deep      | •          |        | _A00-2436-18  | 186 | _A02-2436-18 | 191 |
|               |            | •      | _A10-2436-18  | 186 | _A12-2436-18 | 191 |
| 24" deep      | •          |        | _A00-2436-24  | 195 | _A02-2436-24 | 208 |
|               |            | •      | _A10-2436-24  | 195 | _A12-2436-24 | 208 |
| 30" deep      | •          |        | _A00-2436-30  | 204 | _A02-2436-30 | 217 |
|               |            | •      | _A10-2436-30  | 204 | _A12-2436-30 | 217 |
| 36" deep      | •          |        | _A00-2436-36  | 210 | _A02-2436-36 | 223 |
|               |            | •      | _A10-2436-36  | 210 | _A12-2436-36 | 223 |
| 42" deep      | •          |        | _A00-2436-42  | 213 | _A02-2436-42 | 226 |
|               |            | •      | _A10-2436-42  | 213 | _A12-2436-42 | 226 |

### Components

|                    | LIGHT TRAFFIC |     |              |       | HEAVY DUTY    |     |              |       |
|--------------------|---------------|-----|--------------|-------|---------------|-----|--------------|-------|
|                    | NOT BOLT DOWN |     | BOLT DOWN    |       | NOT BOLT DOWN |     | BOLT DOWN    |       |
|                    | Part No.      | WT. | Part No.     | WT.   | Part No.      | WT. | Part No.     | WT.   |
| Box 18" deep       | _B00-2436-18  | 100 | _B10-2436-18 | 100   | _B02-2436-18  | 105 | _B12-2436-18 | 105   |
| Box 24" deep       | _B00-2436-24  | 109 | _B10-2436-24 | 109   | _B02-2436-24  | 114 | _B12-2436-24 | 114   |
| Box 30" deep       | _B00-2436-30  | 118 | _B10-2436-30 | 118   | _B02-2436-30  | 123 | _B12-2436-30 | 123   |
| Box 36" deep       | _B00-2436-30  | 124 | _B10-2436-30 | 124   | _B02-2436-30  | 129 | _B12-2436-30 | 129   |
| Box 42" deep       | _B00-2436-42  | 127 | _B10-2436-42 | 127   | _B02-2436-42  | 132 | _B12-2436-42 | 132   |
| Cover 3" thick     | _C00-2436-03  | 86  | _C10-2436-03 | 86    | _C02-2436-03  | 94  | _C12-2436-03 | 94    |
| Extension 8" deep  | _E00-2436-08  | 46  | —————        | ————— | _E02-2436-08  | 46  | —————        | ————— |
| Extension 16" deep | _E00-2436-16  | 55  | —————        | ————— | _E02-2436-16  | 63  | —————        | ————— |